

**KEY**

- PROPOSED NO WAITING AT ANY TIME
- - - PROPOSED PARKING MONDAY-SATURDAY 8.30am-6.00pm 20 MINUTES NO RETURN 1 HOUR
- - - PROPOSED DISABLED PARKING BAY - NO TIME LIMIT
- ~ REVOCATION OF EXISTING WAITING, LOADING AND PARKING RESTRICTIONS (NOT VISIBLE IF UNDER PROPOSALS)
- EXISTING WAITING, LOADING AND PARKING RESTRICTIONS (WITH OR WITHOUT SYMBOLS)

Notes

Rev.	Description	Drwn	Sig.	Date	Chkd	Sig.	Date	Appr	Sig.	Date
A	WAITING RESTRICTIONS AMENDED	AJM	AJM	12.12.07	KP	KP	12.12.07	TPC	TPC	12.12.07
B	WAITING RESTRICTIONS AMENDED	SDC	SDC	29.07.08	SDC	SDC	29.07.08	TPC	TPC	29.07.08
C	RESTRICTIONS AMENDED	CAH	CAH	11.15	PW	PW	11.15	RH	RH	11.15
D	RESTRICTIONS AMENDED	CAH	CAH	02.17	PW	PW	02.17	RH	RH	02.17
E	RESTRICTIONS AMENDED	CAH	CAH	06.18	PW	PW	06.18	DC	DC	06.18

Drwn	Sig.	Date	Chkd	Sig.	Date	Appr	Sig.	Date
AJM	AJM	12.12.07	KP	KP	12.12.07	TPC	TPC	12.12.07
SDC	SDC	29.07.08	SDC	SDC	29.07.08	TPC	TPC	29.07.08
CAH	CAH	11.15	PW	PW	11.15	RH	RH	11.15
CAH	CAH	02.17	PW	PW	02.17	RH	RH	02.17
CAH	CAH	06.18	PW	PW	06.18	DC	DC	06.18

Scale 1:1250

Based upon the Ordnance Survey mapping with the permission of the Controller of Her Majesty's Stationery Office. Crown copyright. Unauthorised reproduction infringes Crown copyright and may lead to prosecution or civil proceedings. Surrey County Council LA 076872 1996.

Drawn by SDC Sig. SDC Date 05/05  
 Checked by originator AM Sig. AM Date 05/05  
 Approved by TPC Sig. TPC Date 05/05

Project  
**OLD WOKING DPE WOKING**  
 IMPLEMENTED TRAFFIC ORDERS

SHEET OF

**SURREY COUNTY COUNCIL**  
 Sustainable Development  
 Head of Transport  
 01483 210000  
 01483 210000

Project No. 3282/WOK  
 Contract Sheet No. 20029  
 Drawing No. 20029  
 Rev. E  
 Classification PROPOSAL

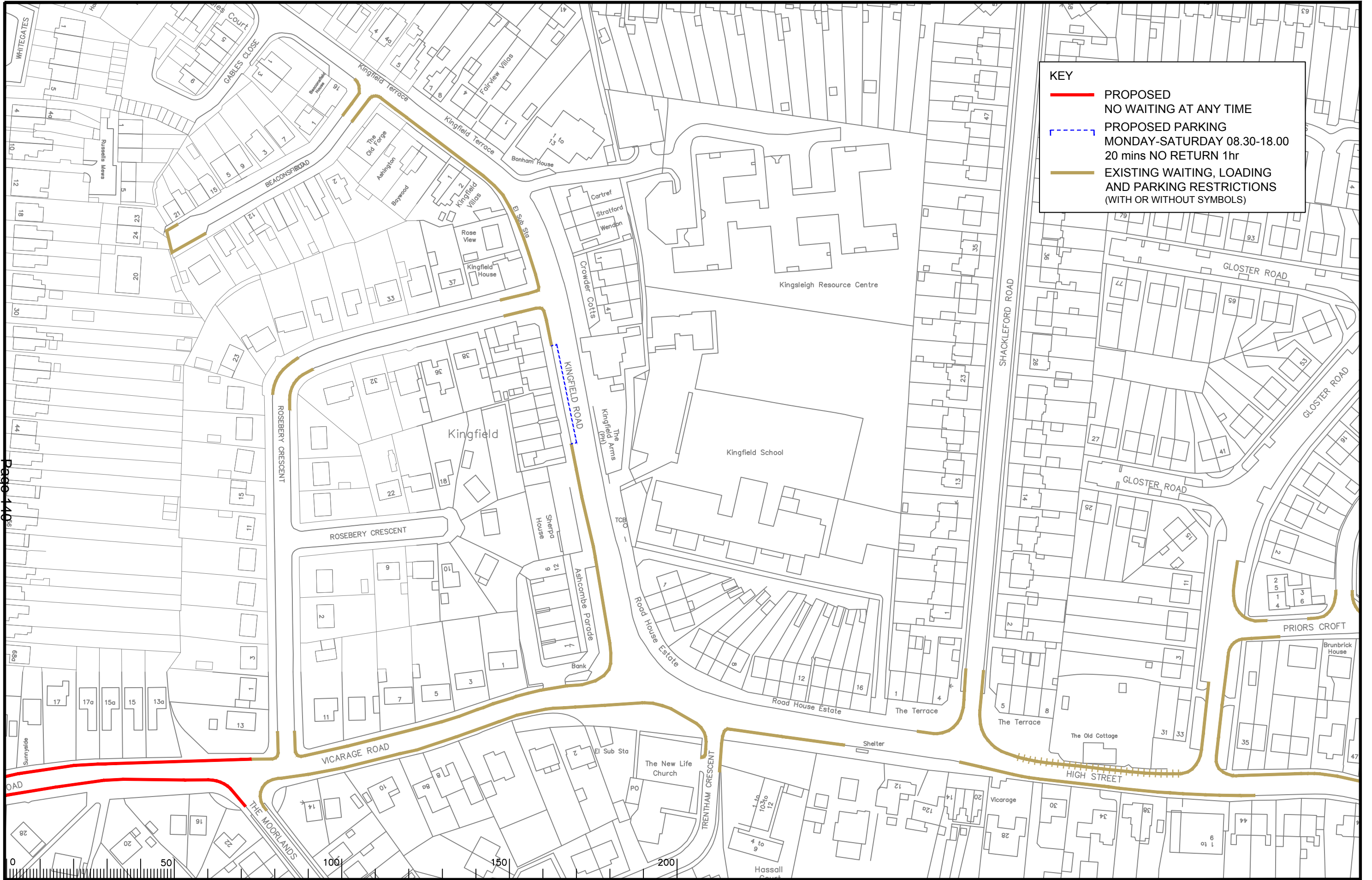

**KEY**

- PROPOSED NO WAITING AT ANY TIME
- - - PROPOSED PARKING MONDAY-SATURDAY 08.30-18.00 20 mins NO RETURN 1hr
- EXISTING WAITING, LOADING AND PARKING RESTRICTIONS (WITH OR WITHOUT SYMBOLS)

Page 140

Notes

Rev.	Description	Drwn	Sig.	Date	Chkd	Sig.	Date	Appr	Sig.	Date
A	WAITING RESTRICTIONS AMENDED	SDC	SDC	29.07.08	SDC	SDC	29.07.08	TPC	TPC	29.07.08
B	RESTRICTIONS AMENDED	CAH	CAH	01.11	JAR	JAR	01.11	TPC	TPC	01.11
C	RESTRICTIONS AMENDED	CAH	CAH	11.11	AH	AH	11.11	TPC	TPC	11.11
D	RESTRICTIONS AMENDED	CAH	CAH	11.15	PW	PW	11.15	RH	RH	11.15
E	RESTRICTIONS AMENDED	CAH	CAH	06.18	PW	PW	06.18	DC	DC	06.18

Based upon the Ordnance Survey mapping with the permission of the Controller of Her Majesty's Stationery Office. Crown copyright. Unauthorised reproduction infringes Crown copyright and may lead to prosecution or civil proceedings. Surrey County Council LA 076872 1996.

Drawn by SDC Sig. SDC Date 05/05  
 Checked by originator AM Sig. AM Date 05/05  
 Approved by TPC Sig. TPC Date 05/05

Project  
**OLD WOKING DPE WOKING**  
 Drawing  
**IMPLEMENTED TRAFFIC ORDERS**

**SURREY COUNTY COUNCIL**  
 Sustainable Development  
 Head of Transport  
 01483 215000  
 01483 215000

Project No. **3282WOK**  
 Contract Sheet No. **20030**  
 Drawing No. **E**  
 Classification **PROPOSAL**

SHEET OF

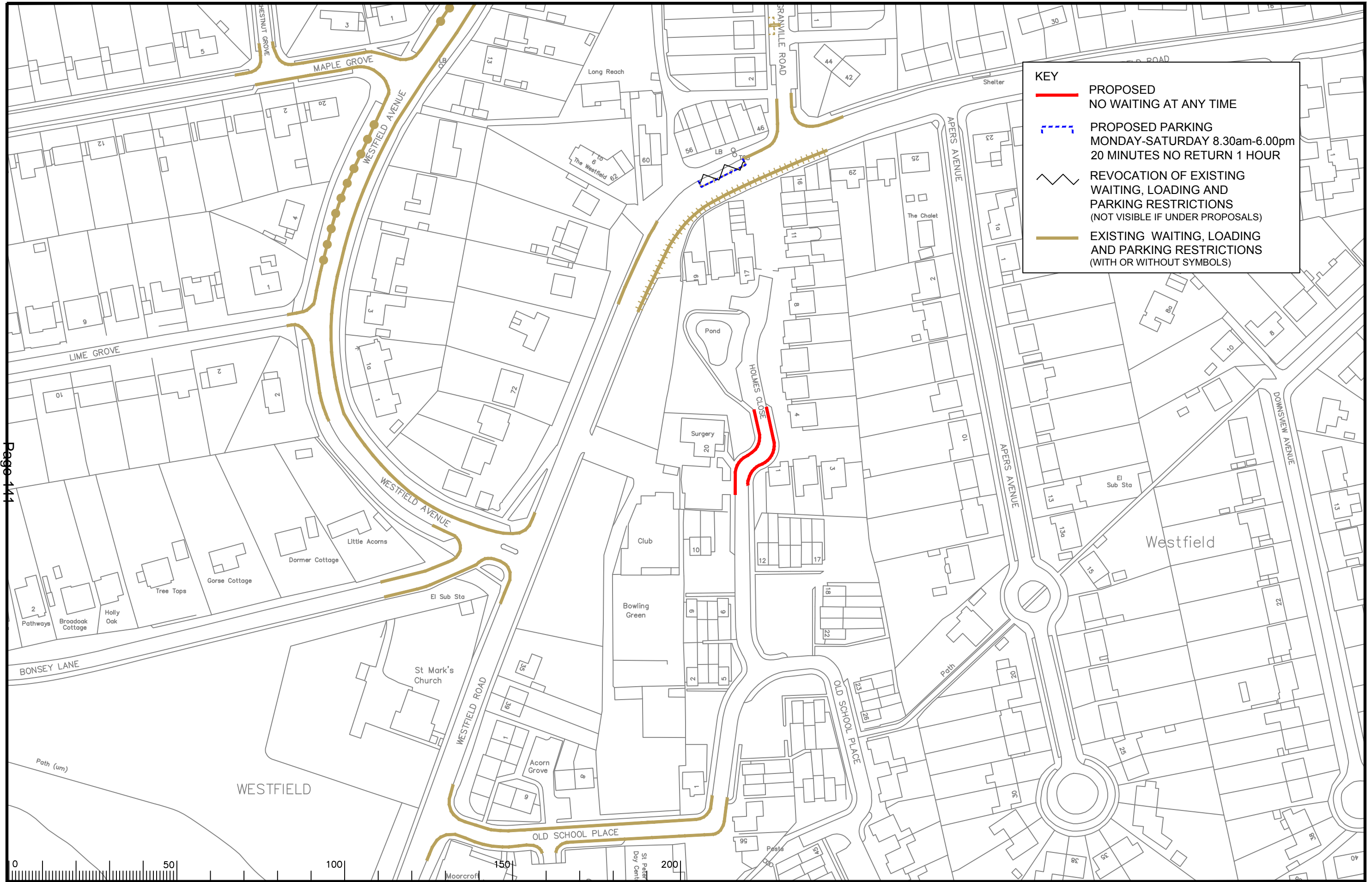

**KEY**

- PROPOSED NO WAITING AT ANY TIME
- - - PROPOSED PARKING MONDAY-SATURDAY 8.30am-6.00pm 20 MINUTES NO RETURN 1 HOUR
- REVOCATION OF EXISTING WAITING, LOADING AND PARKING RESTRICTIONS (NOT VISIBLE IF UNDER PROPOSALS)
- EXISTING WAITING, LOADING AND PARKING RESTRICTIONS (WITH OR WITHOUT SYMBOLS)



Notes

Rev.	Description	Drwn	Sig.	Date	Chkd	Sig.	Date	Appr	Sig.	Date
A	WAITING RESTRICTIONS AMENDED	AJM	AJM	12.12.07	KP	KP	12.12.07	TPC	TPC	12.12.07
B	WAITING RESTRICTIONS AMENDED	SDC	SDC	29.07.08	SDC	SDC	29.07.08	TPC	TPC	29.07.08
C	RESTRICTIONS AMENDED	CAH	CAH	11.11	JAR	JAR	11.11	TPC	TPC	11.11
D	RESTRICTIONS AMENDED	CAH	CAH	05.13	PW	PW	05.13	RH	RH	05.13
E	RESTRICTIONS AMENDED	CAH	CAH	11.15	PW	PW	11.15	RH	RH	11.15
F	RESTRICTIONS AMENDED	CAH	CAH	02.17	PW	PW	02.17	RH	RH	02.17
G	RESTRICTIONS AMENDED	CAH	CAH	06.18	PW	PW	06.18	DC	DC	06.18

Drwn by	Sig.	Date	Checked by	Sig.	Date	Approved by	Sig.	Date
SDC	SDC	05/05	AM	AM	05/05	AS MADE	TPC	05/05

Scale 1:1250

Based upon the Ordnance Survey mapping with the permission of the Controller of Her Majesty's Stationery Office © Crown copyright. Unauthorised reproduction infringes Crown copyright and may lead to prosecution or civil proceedings.  
Surrey County Council LA 076872 1996.

Project: **OLD WOKING DPE WOKING**

Drawing: **IMPLEMENTED TRAFFIC ORDERS**

SHEET OF

**SURREY COUNTY COUNCIL**  
Sustainable Development  
Head of Transport  
01483 210000

Project No. **3282/WOK**  
Contract Sheet No. **20033**  
Drawing No. **G**  
Rev. **G**  
Classification **PROPOSAL**

**KEY**

- PROPOSED NO WAITING AT ANY TIME
- EXISTING WAITING, LOADING AND PARKING RESTRICTIONS (WITH OR WITHOUT SYMBOLS)

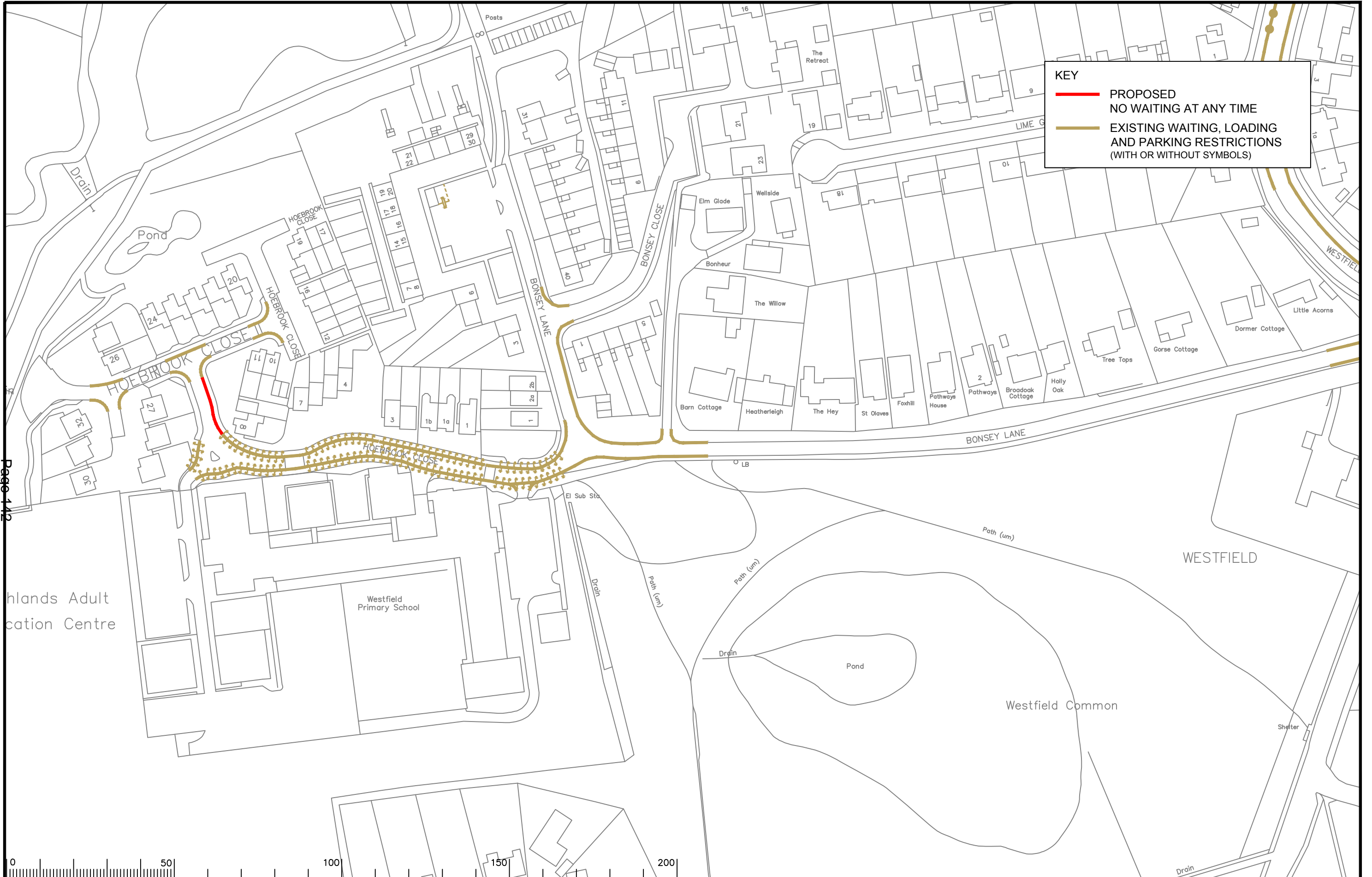

Page 142

lands Adult  
cation Centre

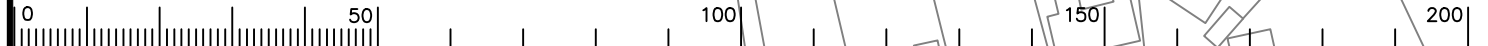

Rev.	Description	Drwn	Sig.	Date	Chkd	Sig.	Date	Appr	Sig.	Date
A	Changes to Bonseley Lane	SDC	SDC	12.12.06	GT	GT	12.12.06	TPC	TPC	12.12.06
B	WAITING RESTRICTIONS AMENDED	AJM	AJM	12.12.07	KP	KP	12.12.07	TPC	TPC	12.12.07
C	RESTRICTIONS AMENDED	CAH	CAH	11.11	JAR	JAR	11.11	TPC	TPC	11.11
D	RESTRICTIONS AMENDED	CAH	CAH	05.13	JAR	JAR	05.13	RH	RH	05.13
E	RESTRICTIONS AMENDED	CAH	CAH	11.15	PW	PW	11.15	RH	RH	11.15
F	RESTRICTIONS AMENDED	CAH	CAH	02.17	PW	PW	02.17	RH	RH	02.17
G	RESTRICTIONS AMENDED	CAH	CAH	06.18	PW	PW	06.18	DC	DC	06.18

Scale 1:1250

Based upon the Ordnance Survey mapping with the permission of the Controller of Her Majesty's Stationery Office © Crown copyright. Unauthorised reproduction infringes Crown copyright and may lead to prosecution or civil proceedings.  
Surrey County Council LA 076872 1996.

Drawn by SDC Sig. SDC Date 05/05  
Checked by AM Sig. AM Date 05/05  
Approved by TPC Sig. TPC Date 05/05

Project  
**WESTFIELD DPE  
WOKING**

Drawing  
**IMPLEMENTED TRAFFIC ORDERS**

SHEET OF

Project No.  
**3282/WOK**

Contract Sheet No.  
**20056**

Rev.  
**G**

Classification  
**PROPOSAL**

**SURREY COUNTY COUNCIL**  
Sustainable Development  
Head of Transportation  
Surrey County Council

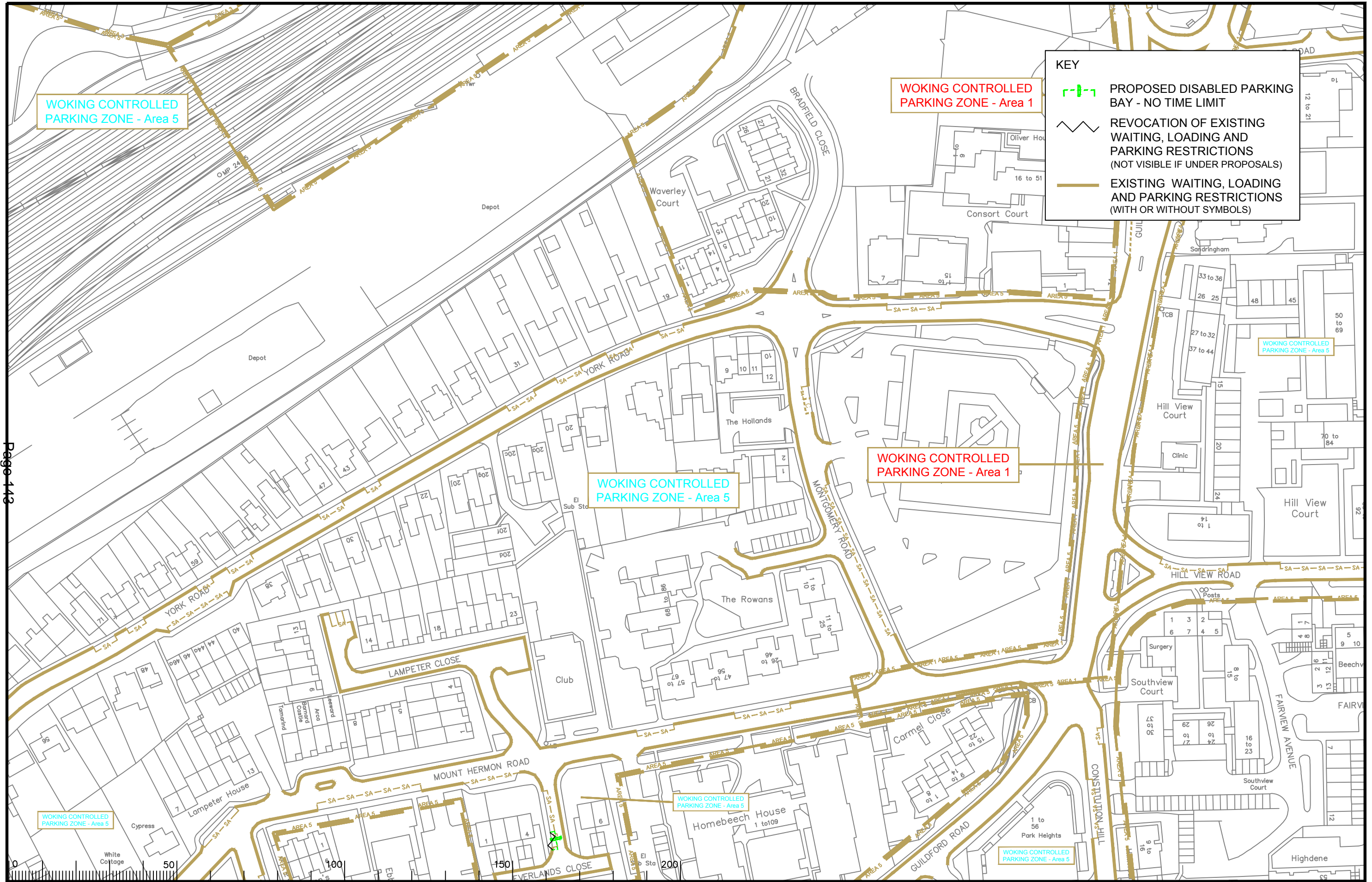

**KEY**

- PROPOSED DISABLED PARKING BAY - NO TIME LIMIT
- REVOCATION OF EXISTING WAITING, LOADING AND PARKING RESTRICTIONS (NOT VISIBLE IF UNDER PROPOSALS)
- EXISTING WAITING, LOADING AND PARKING RESTRICTIONS (WITH OR WITHOUT SYMBOLS)

Notes

Rev.	Description	Drwn	Sig.	Date	Chkd	Sig.	Date	Appr	Sig.	Date
A	Changes to Montgomery Road	SDC	SDC	12.12.06	GT	GT	12.12.06	TPC	TPC	12.12.06
B	WAITING RESTRICTIONS AND LIFESTYLES AMENDED	AJM	AJM	12.12.07	KP	KP	12.12.07	TPC	TPC	12.12.07
C	RESTRICTIONS AMENDED	CAH	CAH	01.11	JAR	JAR	01.11	TPC	TPC	01.11
D	RESTRICTIONS AMENDED	CAH	CAH	11.11	PW	PW	11.11	TPC	TPC	11.11
E	RESTRICTIONS AMENDED	CAH	CAH	05.13	JAR	JAR	05.13	RH	RH	05.13
F	RESTRICTIONS AMENDED	CAH	CAH	11.15	PW	PW	11.15	RH	RH	11.15
G	RESTRICTIONS AMENDED	CAH	CAH	02.17	PW	PW	02.17	RH	RH	02.17
H	RESTRICTIONS AMENDED	CAH	CAH	06.18	PW	PW	06.18	DC	DC	06.18

Based upon the Ordnance Survey mapping with the permission of the Controller of Her Majesty's Stationery Office. Crown copyright. Unauthorised reproduction infringes Crown copyright and may lead to prosecution or civil proceedings. Surrey County Council LA 076872 1996.

Drawn by: SDC  
Checked by: AM  
Approved by: TPC

Sig.: SDC, AM, TPC  
Date: 05/05, 05/05, 05/05

Project: WOKING DPE WOKING SOUTH

Implemented Traffic Orders

SHEET OF

**SURREY COUNTY COUNCIL**  
Sustainable Development  
Head of Transportation  
01483 211100  
01483 211100

Project No. 3282/WOK  
Contract Sheet No. 20091  
Drawing No. 20091  
Rev. H  
Classification: PROPOSAL

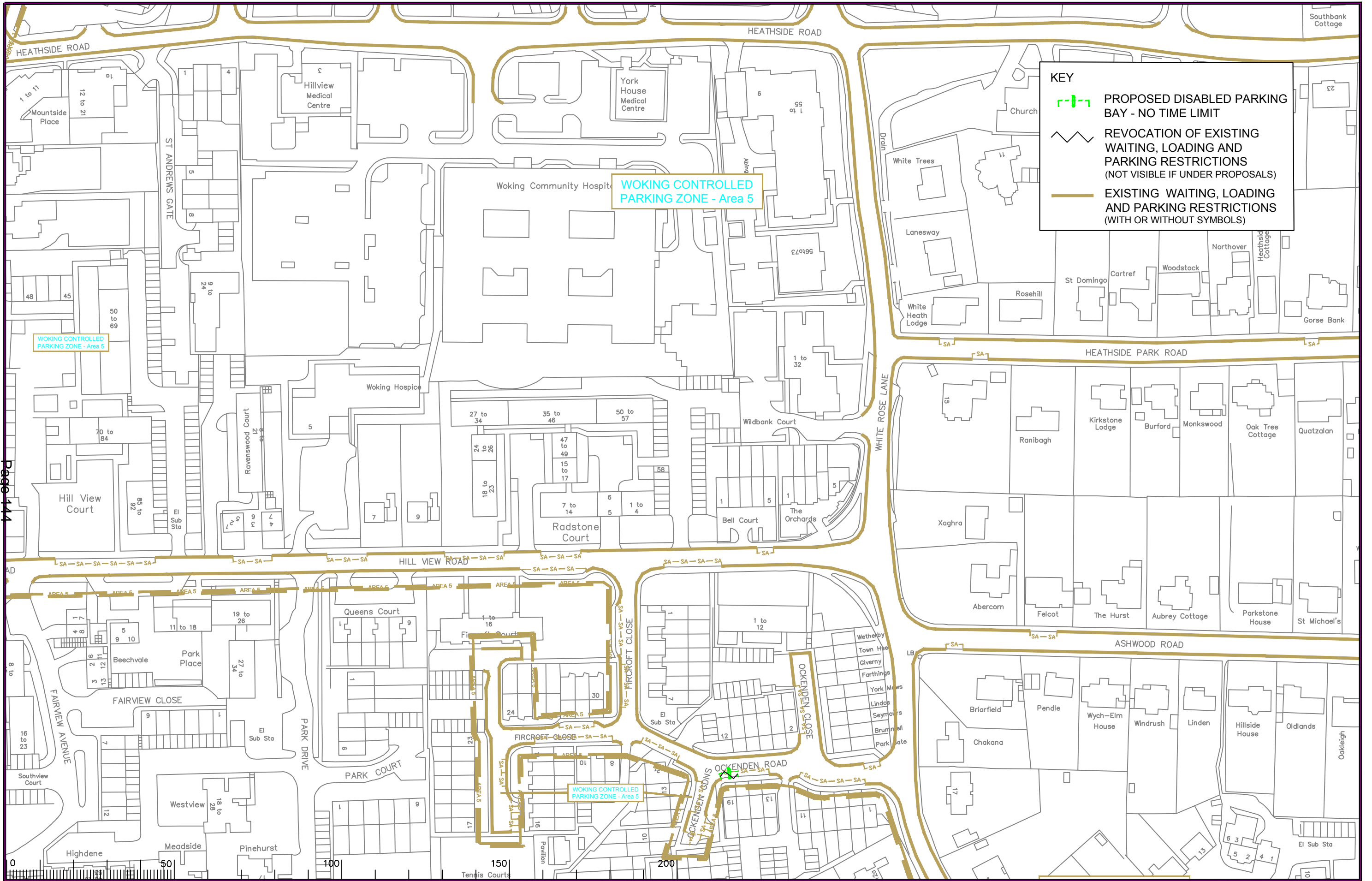

**KEY**

- PROPOSED DISABLED PARKING BAY - NO TIME LIMIT
- REVOCATION OF EXISTING WAITING, LOADING AND PARKING RESTRICTIONS (NOT VISIBLE IF UNDER PROPOSALS)
- EXISTING WAITING, LOADING AND PARKING RESTRICTIONS (WITH OR WITHOUT SYMBOLS)

WOKING CONTROLLED PARKING ZONE - Area 5

WOKING CONTROLLED PARKING ZONE - Area 5

WOKING CONTROLLED PARKING ZONE - Area 5

Page 144

**Notes**

Rev.	Description	Drwn	Sig.	Date	Chkd	Sig.	Date	Appr	Sig.	Date
A	Changes to Heathside Park Road	SDC	SDC	12.12.06	GT	GT	12.12.06	TPC	TPC	12.12.06
B	WAITING RESTRICTIONS AND LIFESTYLES AMENDED	AJM	AJM	12.12.07	KP	KP	12.12.07	TPC	TPC	12.12.07
C	RESTRICTIONS AMENDED	CAH	CAH	11.11	PW	PW	11.11	TPC	TPC	11.11
D	RESTRICTIONS AMENDED	CAH	CAH	05.13	JAR	JAR	05.13	RH	RH	05.13
E	RESTRICTIONS AMENDED	CAH	CAH	08.14	PW	PW	08.14	RH	RH	08.14
F	RESTRICTIONS AMENDED	CAH	CAH	08.18	PW	PW	08.18	DC	DC	08.18

Rev.	Description	Drwn	Sig.	Date	Chkd	Sig.	Date	Appr	Sig.	Date
A	Changes to Heathside Park Road	SDC	SDC	12.12.06	GT	GT	12.12.06	TPC	TPC	12.12.06
B	WAITING RESTRICTIONS AND LIFESTYLES AMENDED	AJM	AJM	12.12.07	KP	KP	12.12.07	TPC	TPC	12.12.07
C	RESTRICTIONS AMENDED	CAH	CAH	11.11	PW	PW	11.11	TPC	TPC	11.11
D	RESTRICTIONS AMENDED	CAH	CAH	05.13	JAR	JAR	05.13	RH	RH	05.13
E	RESTRICTIONS AMENDED	CAH	CAH	08.14	PW	PW	08.14	RH	RH	08.14
F	RESTRICTIONS AMENDED	CAH	CAH	08.18	PW	PW	08.18	DC	DC	08.18

Scale 1:1250

Based upon the Ordnance Survey mapping with the permission of the Controller of Her Majesty's Stationery Office. Crown copyright. Unauthorised reproduction infringes Crown copyright and may lead to prosecution or civil proceedings. Surrey County Council LA 076872 1996.

Drawn by SDC Sig. SDC Date 05/05  
 Checked by originator AM Sig. AM Date 05/05  
 Approved by TPC Sig. TPC Date 05/05

Project: WOKING DPE WOKING

Drawing: IMPLEMENTED TRAFFIC ORDERS

SHEET OF

**SURREY COUNTY COUNCIL**  
Sustainable Development  
Head of Transportation  
Surrey County Council LA 076872 1996

Project No. 3282/WOK  
 Contract Sheet No. 20092  
 Drawing No. 20092  
 Rev. F  
 Classification: PROPOSAL